

FAST CONSTRUCTION  
LIGHT AND STRONG  
MODULAR BUILDING  
COMFORT AND QUALITY

**THE PERFECT  
BUILDING  
SOLUTION**



**AIRCRETE** | BUILDING SYSTEM

**AIRCRETE**  
EUROPE

Autoclaved Aerated Concrete

# AAC HOUSING SOLUTION

Autoclaved Aerated Concrete (aircrete) is nowadays the **most suitable building material for sustainable construction**. The extensive product portfolio and outstanding material characteristics create the perfect foundation for modular, fast and eco-friendly housing solutions which **outperform traditional building materials**.

**MODULAR,  
FAST AND  
ECO-FRIENDLY**

Manufacturing a complete AAC building solution is a next step towards your market expansion. Beyond the existing AAC blocks commodity market, there is a growing worldwide demand for integrated panel-based building solutions.

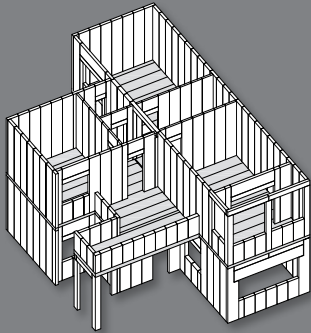

## AIRCRETE BUILDING SYSTEM

Aircrete supports development of your local market through design of innovative buildings systems suited for **residential, commercial and social housing** construction.

We design **new solutions or convert existing buildings** into an optimized AAC building system. The dimensions of the panels are standardized to fit the optimal product portfolio of Aircrete factories. (floors, walls, roofs, lintels) Application of an Aircrete housing solution results in direct **time and cost savings in construction**.

### Identify - Housing Design

Use existing design (Customer) or New design (Aircrete)

### Determine - Local Conditions

Climate zone, wind category, soil type, seismic activity

### Design - Plan of the Building

Establish general architecture design using aircrete elements

### Finalise - Detailed report

- Building drawing and Calculation report
- Part List - total amount and dimensions of wall, floor, roof panels
- Finishing elements (anchors, roof, windows, doors, electrical, etc.)

### Calculate - Total Project Cost

Engineering + manufacturing + construction + finishing

1



2



3



4



5





# UNIQUE ADVANTAGES OF AIRCRETE BUILDING SYSTEM

Light and easy installation

Reduced time and labor requirements

Large format prefab panels

**SUPER SMOOTH** surfaces = no plastering

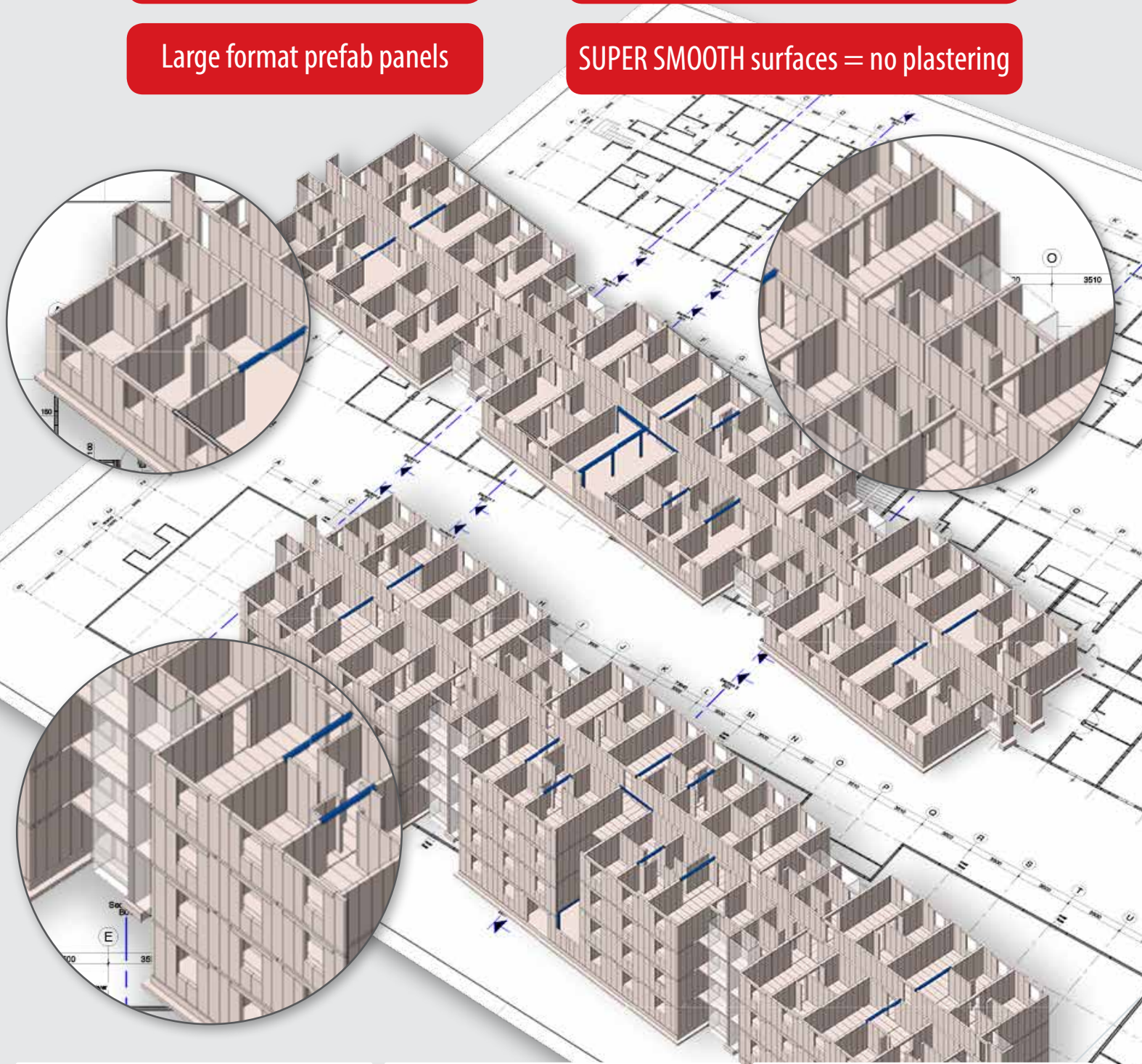



# AIRCRETE INDUSTRIAL SOLUTION

With only **25% of traditional concrete panel weight**, Aircrete panels allow for **easy handling**, **reduced construction time** and **effective labor allocation** due to their **simple installation** system.



*Construction site in the Netherlands.*



*Industrial warehouse in Belgium.*



*Construction site in the Netherlands.*



*Burger King in Germany.*

Aircrete prefab panels are a perfect solution to construct large scale commercial and industrial buildings. From giant distribution centers to modern shopping malls, Aircrete walls protect valuable goods as they are a proven firewall solution.



## Unsurpassed fire protection

Aircrete wall panels do not burn, maximizing safety and reducing insurance costs

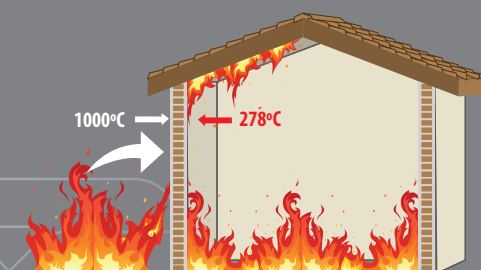

Concrete - 150 mm wall thickness

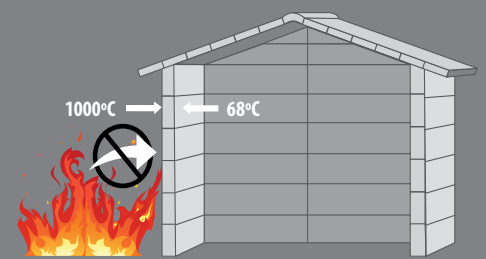

Aircrete - 150 mm wall thickness

## ALL ELEMENTS MADE IN ONE AIRCRETE FACTORY

The AIRCRETE Building System is an established **modular construction concept** that uses reinforced prefab AAC panels and specials to create customized housing solutions. **Precise product dimensions, load bearing capacities, ease of handling and light weight** contribute to a superior building technique with AAC panels.

### FLOOR AND ROOF PANELS

- Superior natural insulation
- Light and strong (load-bearing)

### WALL PANELS

- Excellent fire resistance
- Exact fit on site (no waste)

### PARTITION PANELS

- Time and cost efficient installation
- Easy finish

SUPER SMOOTH surface

SUPER SMOOTH surface

### NORMAL BLOCKS

- 50-500mm thickness
- 300-800 kg/m<sup>3</sup> density

SUPER SMOOTH surface

### ROUNDED BLOCKS

- Flexibility in design
- Creativity in application

### CLADDING PANELS

- Extra light facade structure
- Thickness 37-50mm
- Customized profile design

### LINTELS

- High load-bearing capacity
- Versatile application (up to 3m long)

SUPER SMOOTH surface







**AIRCRETE**  
EUROPE  
Autoclaved Aerated Concrete

Stay in touch with Aircrete Europe:



[www.aircrete-europe.com](http://www.aircrete-europe.com)



Aircrete Europe  
Münsterstraat 10  
7575 ED Oldenzaal  
The Netherlands

Tel: +31 (0) 541 571020  
Email: [info@aircrete.nl](mailto:info@aircrete.nl)